



**Feature -**

- medium size,
- bi-color LED illuminated available
- long electrical life
- SMT and vertical PCB terminal
- symbol film available between the cap and diffuser

**Application -**

- consumer products
- computer products
- instrumentation
- communication equipments

### ► SPECIFICATIONS

SWITCH SPECIFICATIONS	
POLE - POSITION	1P1T , with LED
CONTACT RATING	12 V DC , 50 mA
CONTACT RESISTANCE	100 mΩ MAX. 1.5 V DC ; 100 mA , by Method of Voltage DROP
INSULATION RESISTANCE	100 MΩ MIN. 500 V DC
DIELECTRIC STRENGTH	Breakdown is not Allowable ; 500 V AC for 1 Minute
OPERATING FORCE	250 ± 50 gf
OPERATING LIFE	100,000 cycles
OPERATING TEMPERATURE RANGE	-20°C ~ 70°C
TOTAL TRAVEL	0.35 ± 0.1 mm

LED SPECIFICATIONS							
ATTENTION LEDs are Electrostatic Sensitive devices		Unit	Value / LED Color				
			Blue	Green	Red	White	Yellow
FORWARD CURRENT	If	mA	10	20	20	2	20
REVERSE VOLTAGE	Vr	V	5.0	5.0	5.0	5.0	5.0
REVERSE CURRENT	Ir	μA	10	10	10	10	10
FORWARD VOLTAGE	Vf	V	@ 10mA 3.0-4.0	2.1-2.5	2.0-2.5	@ 2mA 2.8-4.0	2.0-2.5
LUMINOUS INTENSITY	Iv	mcd	@ 10mA 200	800	1800	@ 2mA 12	1800

■ Physical and electrical information of LED will be provided upon customer's request on switches .

### ► HOW TO ORDER

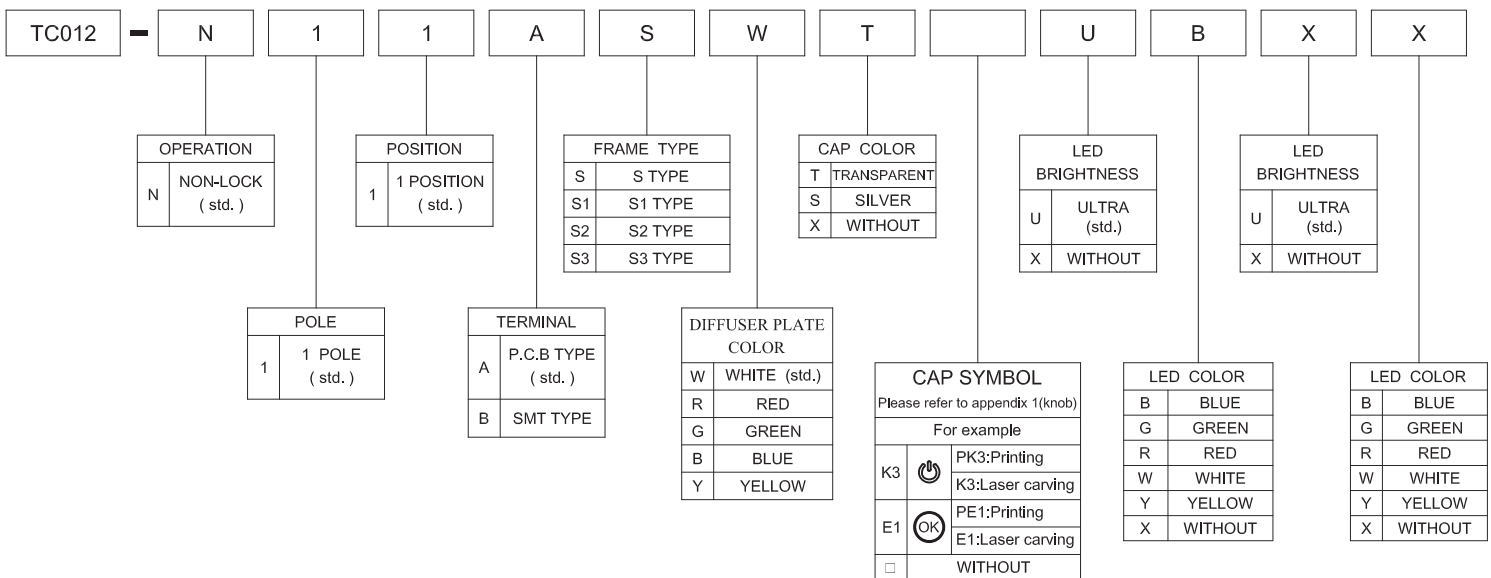

# TC012 SERIES

LED TACT SWITCH

## ► DIMENSION

TC012-N11ASWT

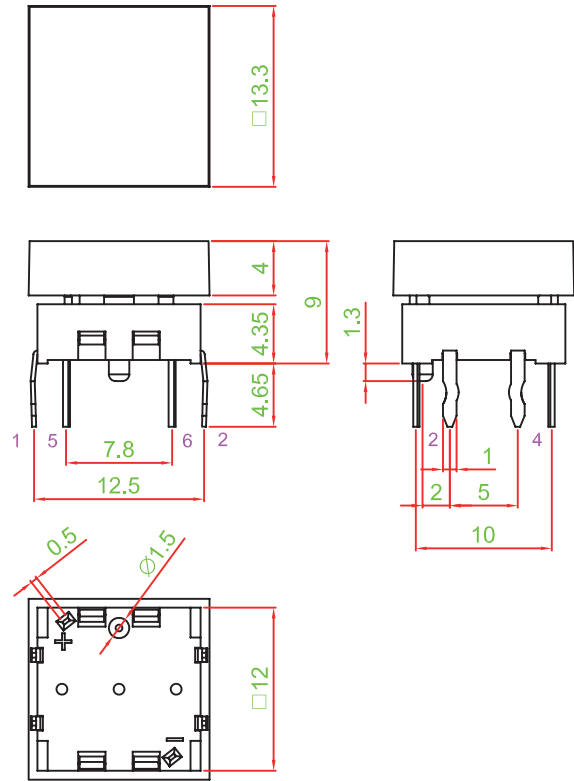

TC012-N11ASWX

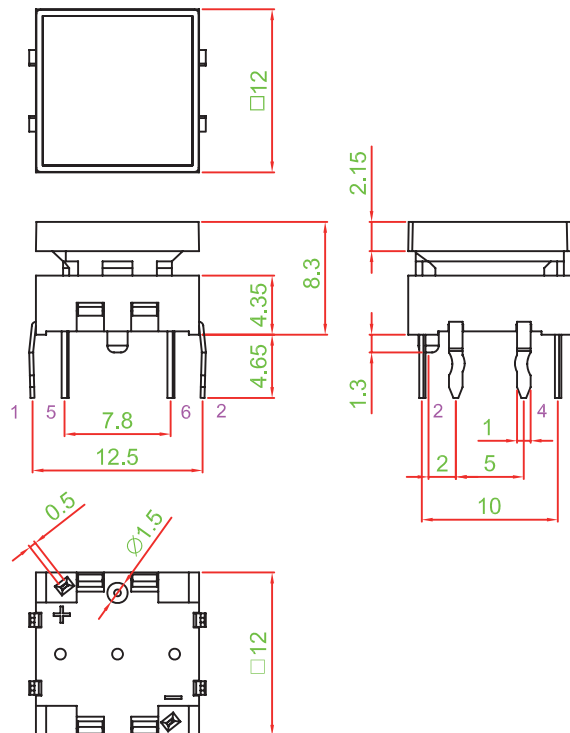

► DIMENSION

TC012-N11AS1WT □□□□

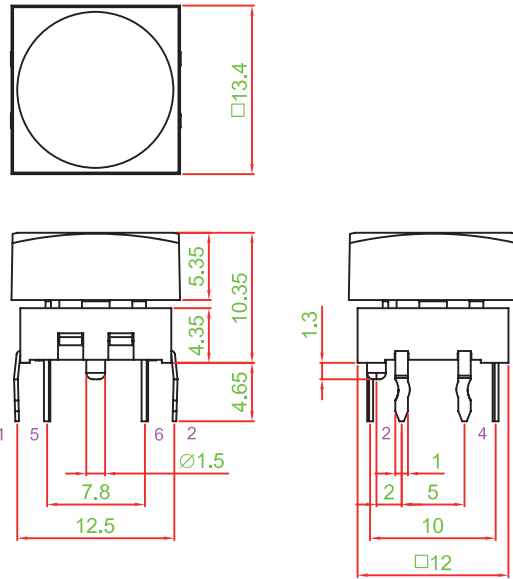
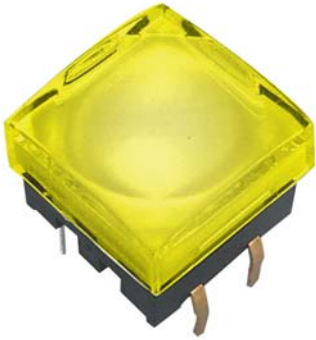

TC012-N11AS2WT □□□□

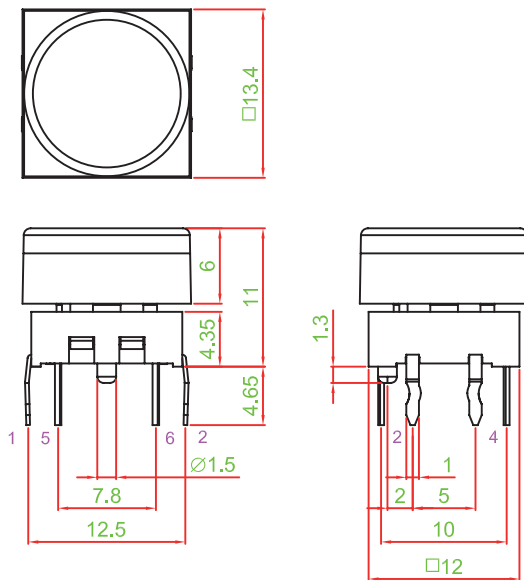

TC012-N11AS3WT □□□□

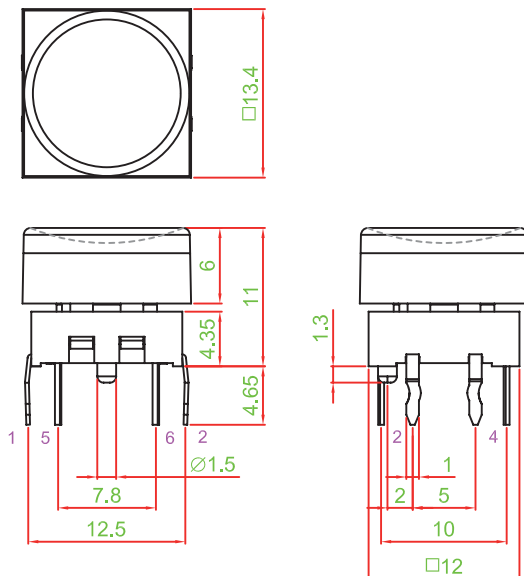

# TC012 SERIES

LED TACT SWITCH

## ► DIMENSION

TC012-N11BSWT □□□□

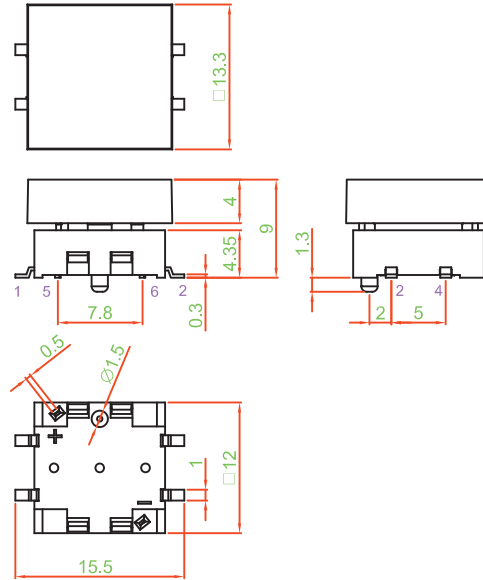

## ► CIRCUIT

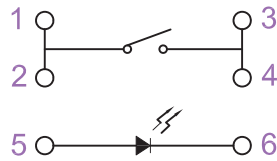

## ► P.C.B LAYOUT

SMT TYPE

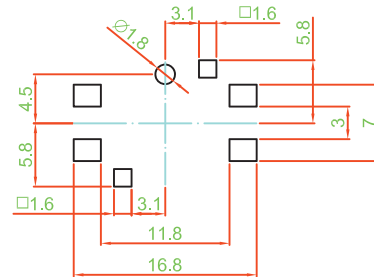

## ► REFLOW SOLDERING

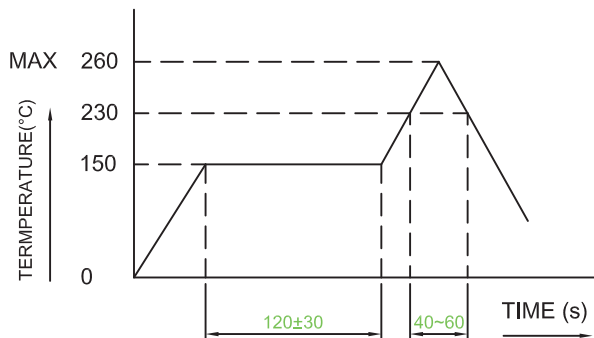

P.C.B TYPE

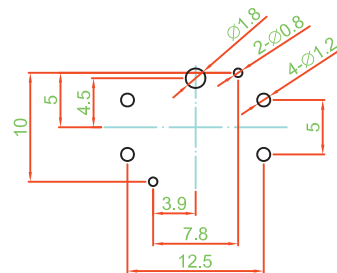

## ► MATERIAL

- ACTUATOR : PA+GF
- TERMINAL : BRASS GOLD FLASH
- BASE FRAME : PA+GF
- COVER : PC

## ► UNIT WEIGHT

- TC012-N11ASWXUBXX : 0.85 ± 0.05 g / pc
- TC012-N11ASWTUBXX : 1.3 ± 0.05 g / pc
- TC012-N11BSWTUBXX : 1.28 ± 0.05 g / pc

